

## Versatile Box for Power or Low Voltage

Mount security cameras, fixtures, detectors, and more inside or out.

### FEATURES AND BENEFITS

- Non-metallic, UV rated for long outdoor life
- OPTION For cameras with base diameter smaller than 4.5" use Arlington's SC5 CAM-KIT™ camera mounting kit on top of the box.
- Mounts security cameras, electrical accessories and fixtures indoors or outdoors
- Screw pattern matches standard 4" fixture box
- Box includes 3/4" to 1/2" reducing bushing



8161BR



8161CB



8161BP



8161BPBL



8161TR

Scan For Video



| CATALOG NUMBER | UPC/DCI/NAED MFG #018997 | DESCRIPTION                        | WEIGHT RATING                | UNIT PKG | STD PKG | DIM A  | DIM B | DIM C |
|----------------|--------------------------|------------------------------------|------------------------------|----------|---------|--------|-------|-------|
| 8161BR         | 08881                    | Box w/ built-in bracket            | 50 lb/wall                   | 1        | 10      | 7.148  | 6.031 | -     |
| 8161BP         | 08880                    | Box w/ built-in base plate         | 50 lb/down rod               | 1        | 10      | 7.046  | .844  | 3.500 |
| 8161BPBL       | 12785                    | Box w/ built-in base plate (black) | 50 lb/down rod               | 1        | 10      | 7.046  | .844  | 3.500 |
| 8161CB         | 01530                    | Box w/ corner-mount bracket        | 50 lb/corner                 | 1        | 10      | 10.851 | 6.450 | -     |
| 8161TR         | 00878                    | Box w/ threaded openings           | 50 lb/ceiling;<br>10 lb/wall | 1        | 10      | 6.720  | 1.343 | -     |

\*Add suffix "GC" to Catalog # when ordering in Canada to include grounding clip, for example 8161BRGC.  
**PATENTED.**

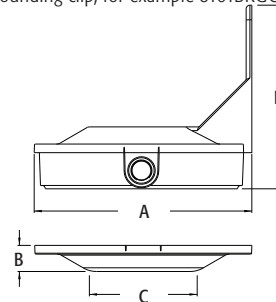

### INSTALLATION SHOTS



8161BP



8161BR



8161CB



8161BPBL