

Weatherproof Box Holder



Zinc die-cast and non-metallic.

CATALOG NUMBER	UPC/DCI/NAED MFG #018997	TRADE SIZE	UNIT PKG	STD PKG	DIM A	DIM B	DIM C	DIM D
FS50	61050	1/2	25	25	.380	1.550	1.125	.860
FS75	61075	3/4	25	25	.380	1.550	1.125	.860
NMFS50*	54050	1/2	25	25	.437	1.792	1.121	.870
NMFS75	54075	3/4	25	25	.437	1.875	1.070	.870

*UV rated non-metallic body.

Note: Can be used as an external means of support to meet the requirements of 2017 NEC Section 314.23.

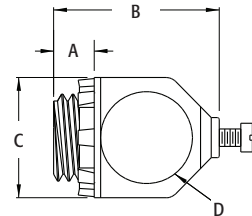

ASSEMBLY INSTRUCTIONS

Just screw the box support into the electrical box; the entire assembly is held secure with a 1/2" rigid steel conduit or water pipe.

Other Uses

- Stubbing up electrical enclosures above concrete slabs with rigid pipe.
- Suspending electrical boxes with rigid pipe between bar joists.
- Suspending fire alarms (smoke detectors) with rigid pipe between bar joists.
- Can be used for installation of equipment where a rigid pipe can be used for a holding means and a 1/2" knockout is present for attachment.

