

SNAP²IT[®] Duplex Connectors with Insulated Throat

FLEX • AC • MC



383810AST



404010AST

Zinc die-cast. For AC • MCI-A • HCF steel and aluminum cable • Flexible metal conduit steel and aluminum (regular and reduced wall) • MCI cable • Continuous corrugated aluminum • ACG90 • AC90.

SNAP-TITE[®] and SNAP2IT[®] products have been tested and listed by UL in accordance with UL's ground fault requirements. For additional information see page 8.

CATALOG NUMBER	UPC/DCI/NAED MFG #018997	TRADE SIZE	KO SIZE	UNIT PKG	STD PKG	DIM A	DIM B	DIM C	DIM D	CABLE RANGE
383810AST	10937	3/8	1/2	25	100	2.467	2.035	.840	.624	(2) .370 - .490
404010AST	40533	3/8	1/2	25	100	2.467	2.115	.840	.624	(2) .405 - .612
505010AST*	50720	1/2	3/4	25	25	3.054	2.717	1.058	.810	(2) .650 - .850

Provided with red tinted inside clip so you can tell the difference between a 383810AST & 404010AST.

CSA Listed with anti-short bushing ONLY.

*Also for MC-PCS Cable.

Refer to chart on page E-27 for list of cable types.

See page E-30 and E-31 for MCI-A cable ranges.

Concrete tight when taped.

PATENTED.



For the **WIDEST TOTAL CABLE RANGES**

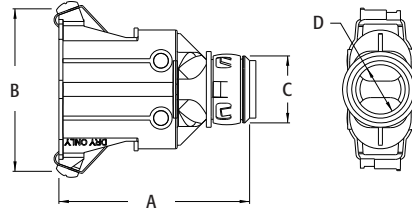

LISTED SNAP2IT[®] CONNECTORS FOR NEW MC-PCS CABLE
Lighting & Low Voltage circuits in the same cable

INSTALLATION INSTRUCTIONS

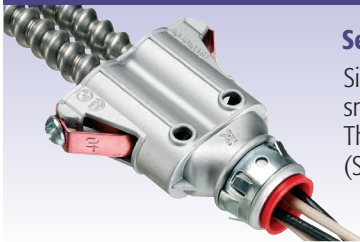

Secure hold—Easy cable insertion!

Simply snap the cable into the fitting and snap it into the box...no tools needed! The screw only holds the clip in place. (See page E-1 for ring removal instructions.)