

"Take All" Connectors

Single screw saddle type. For NM • Flex • AC • AC90 • MCI steel and aluminum jacketed cables • ACG90 • Teck90. Zinc die-cast.

CATALOG NUMBER	UPC/DCI/NAED MFG #018997	TRADE SIZE	KO SIZE	UNIT PKG	STD PKG	DIM A	DIM B	DIM C	CABLE RANGE	END STOP DIAMETER
L15A*	80040	3/8	1/2	50	500	1.013	.400	1.094	.460 - .585	.340 x .430
L16†‡	80060	3/8	1/2	50	500	.965	.408	1.094	.405 - .650	.400 x .580
L160‡	02416	3/8	1/2	50	500	.954	.412	1.092	.370 - .690	.312
L17	34278	1/2	1/2	50	250	1.425	.400	1.424	.630 - .890	.620
L18	34282	3/4	3/4	25	125	1.475	.490	1.750	.820 - 1.040	.818
L19	34287	1	1	25	125	1.651	.452	2.047	1.100 - 1.400	1.030



L15A

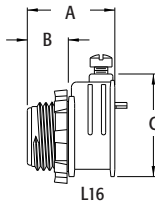

Refer to chart on page E-27 for list of cable types.
 ‡Also for MCI-A cable. See page E-30 and E-31 for MCI-A cable ranges.

*Provided with insulated throat.
 †Listed for flexible cord.
 Concrete tight when taped.

FLEX • AC • MC